

Detalhe de Ligação

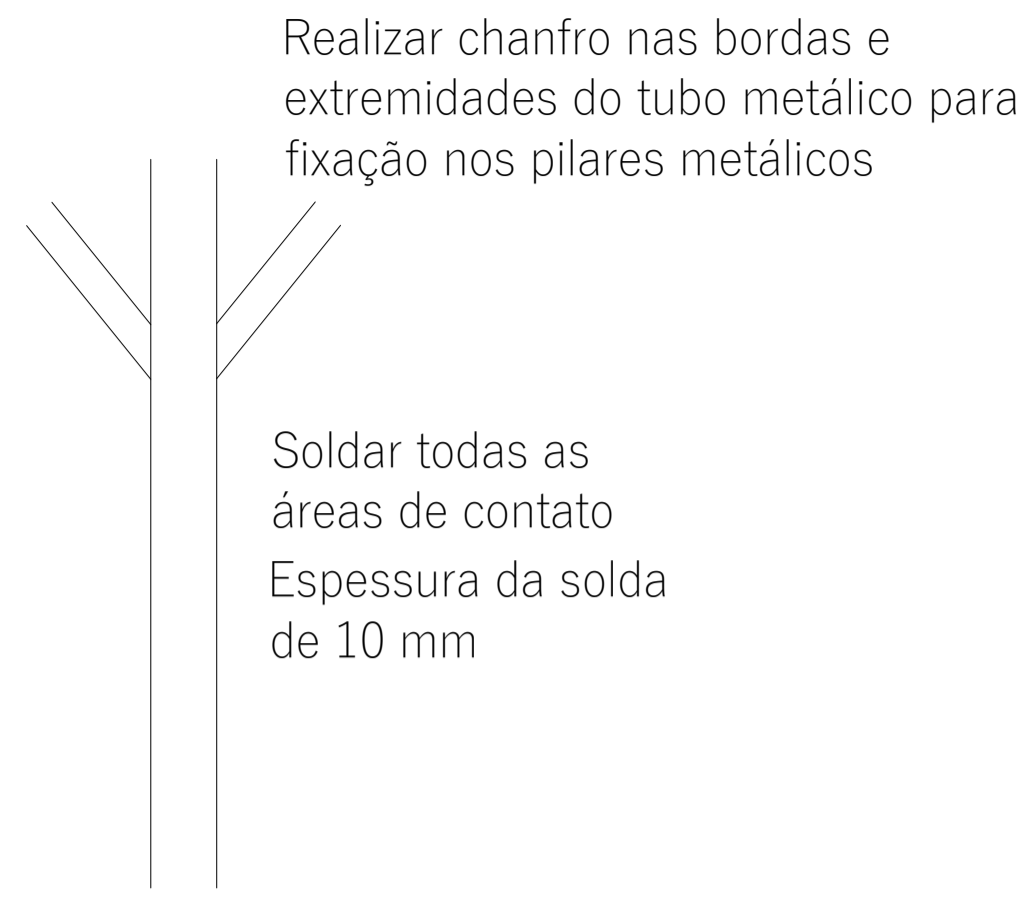

Detalhe de apoio com barra chata

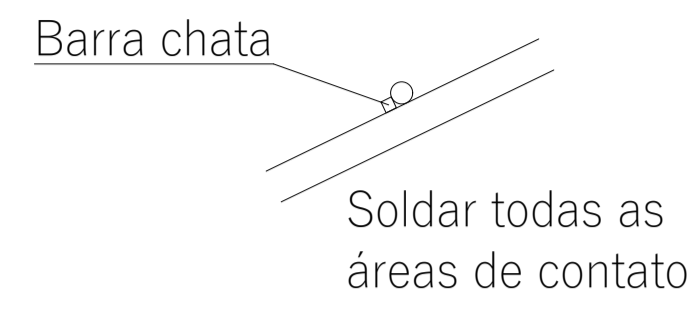

Detalhe de Ligação

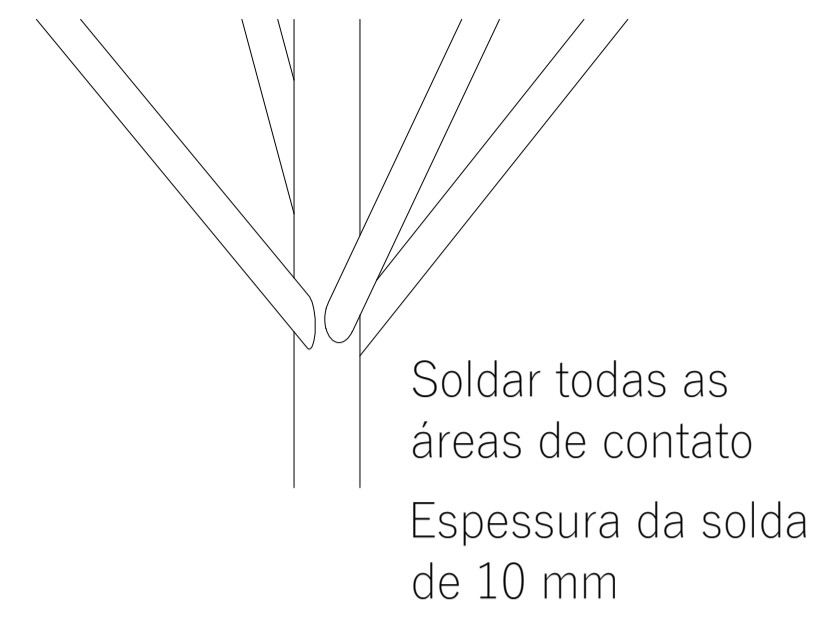

Detalhe de Ligação



Detalhe de solda

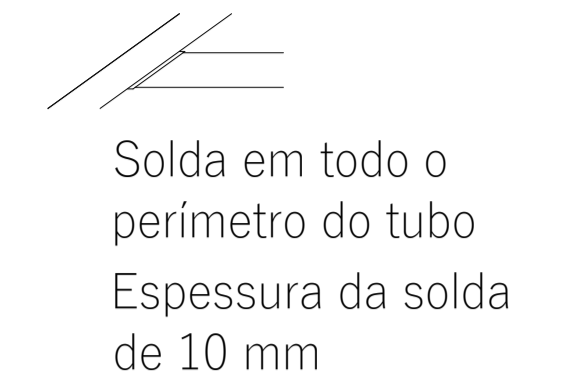

Braçadeira para fixação das telhas

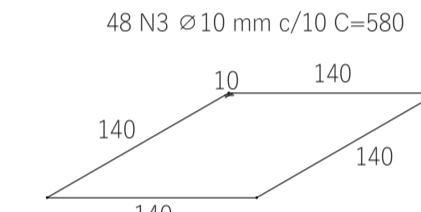
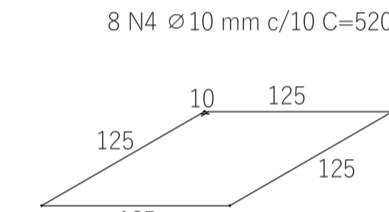
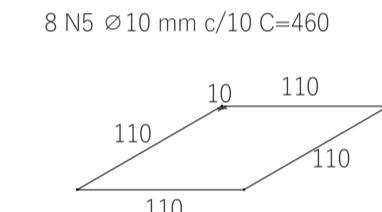
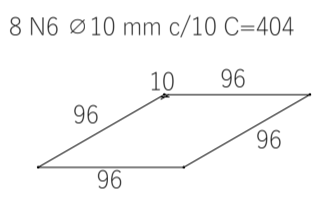
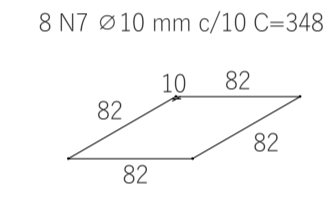
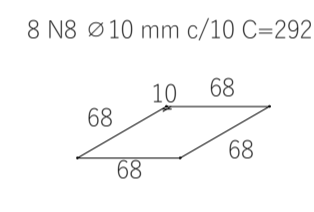
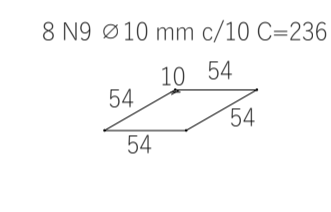
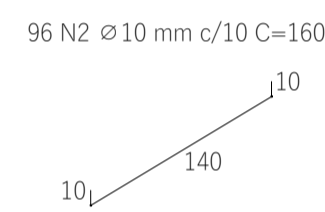
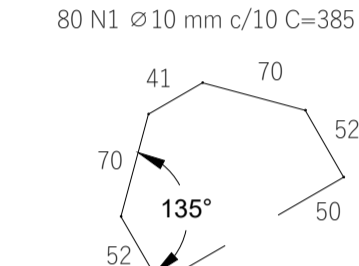
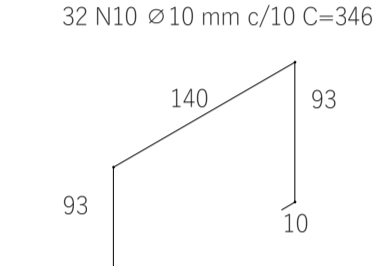
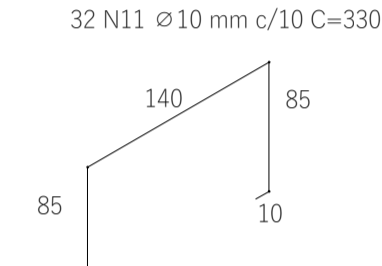
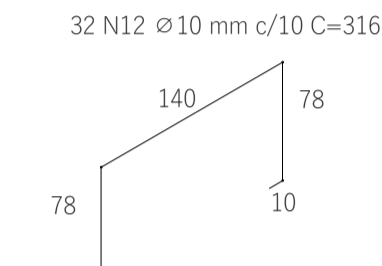
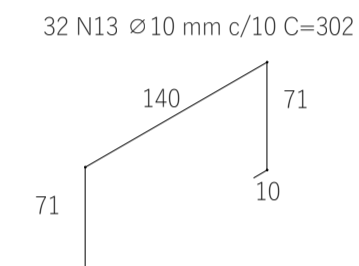
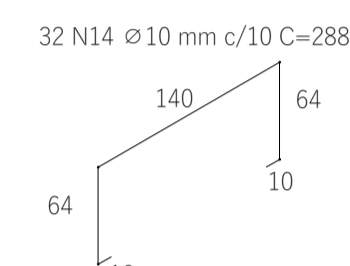
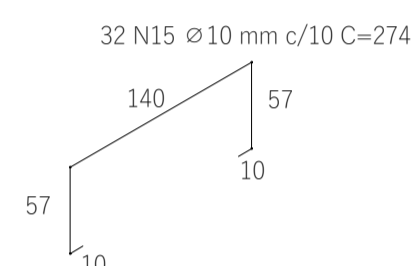
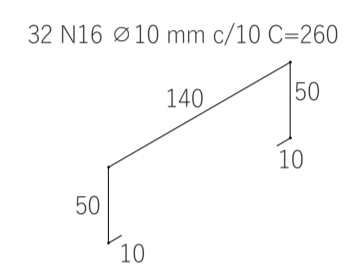

Detalhe de ligação

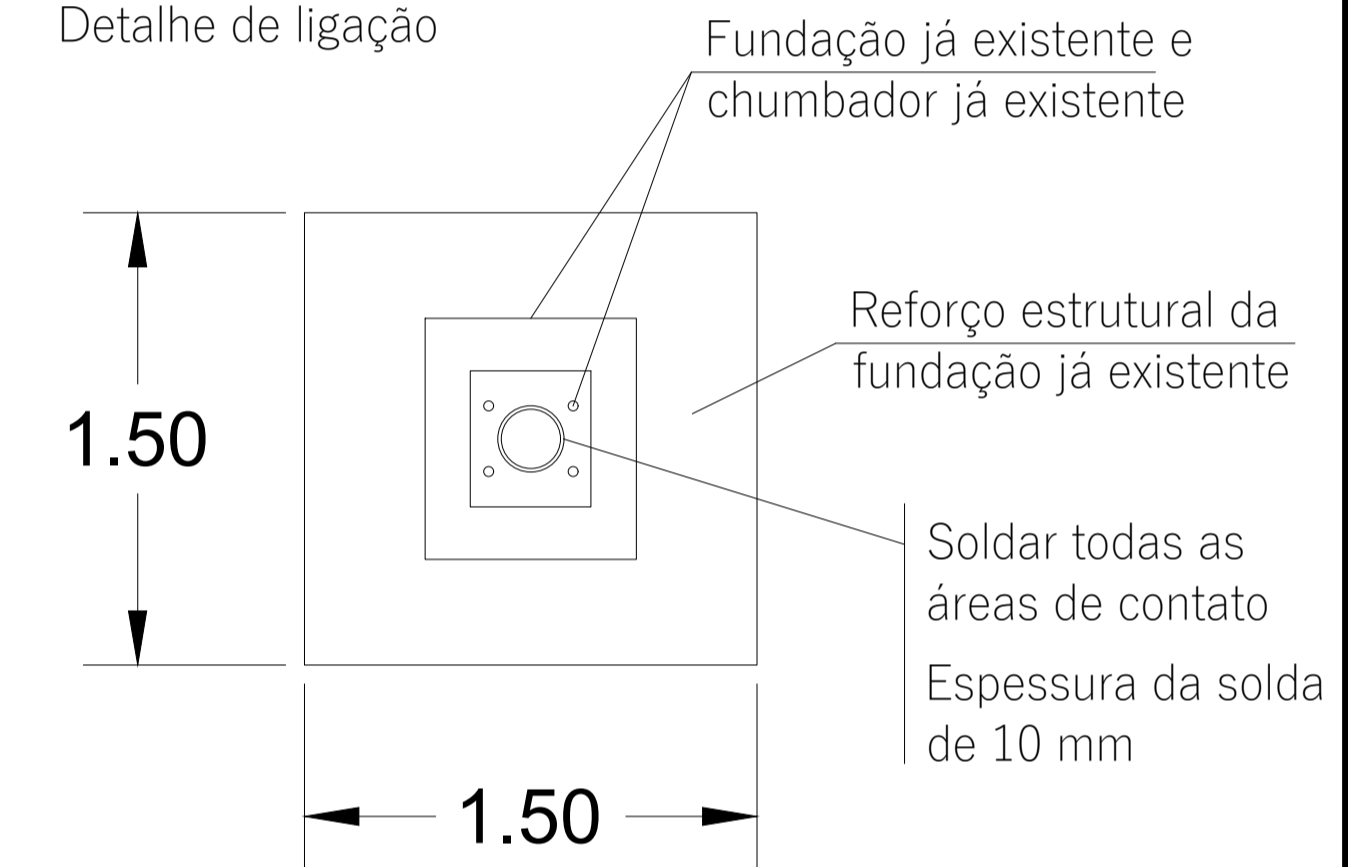

CORTE DO REFORÇO DA FUNDAÇÃO
ARMADURA VERTICAL
ESCALA 1:25

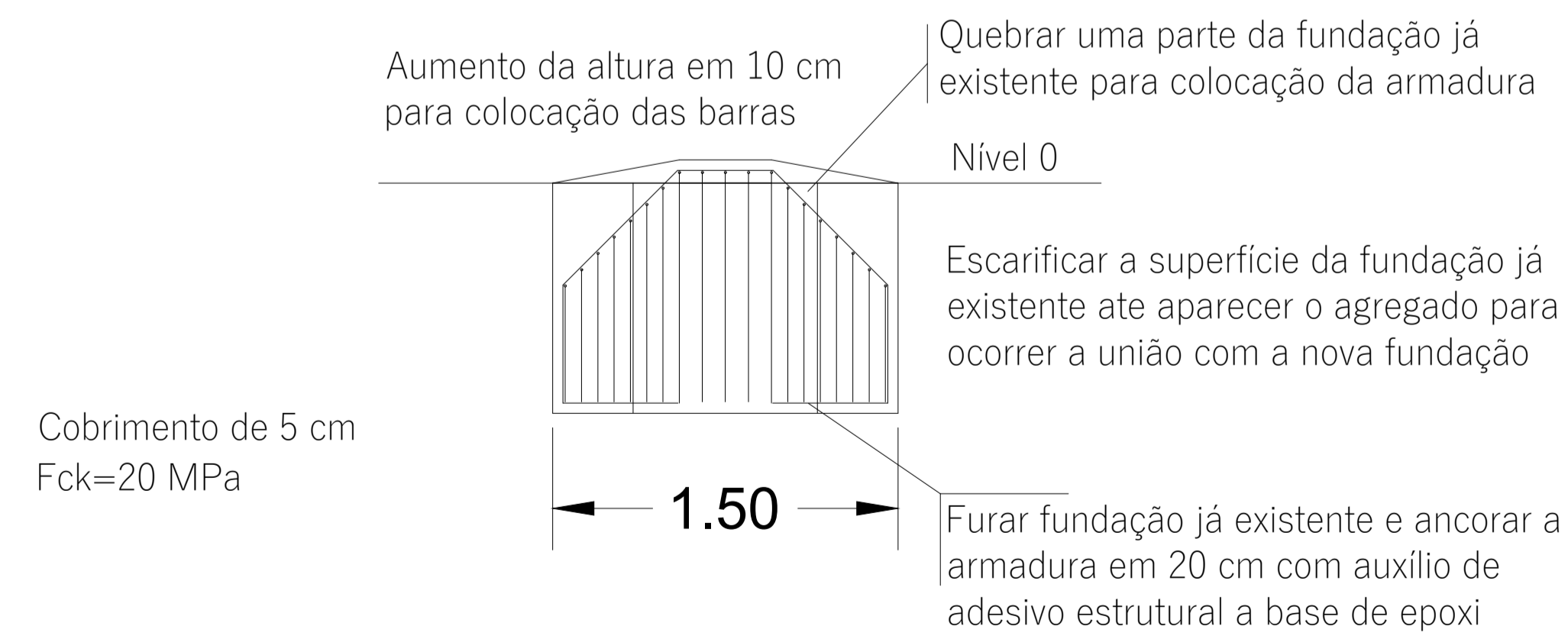

CORTE DO REFORÇO DA FUNDAÇÃO
ARMADURA HORIZONTAL
ESCALA 1:25

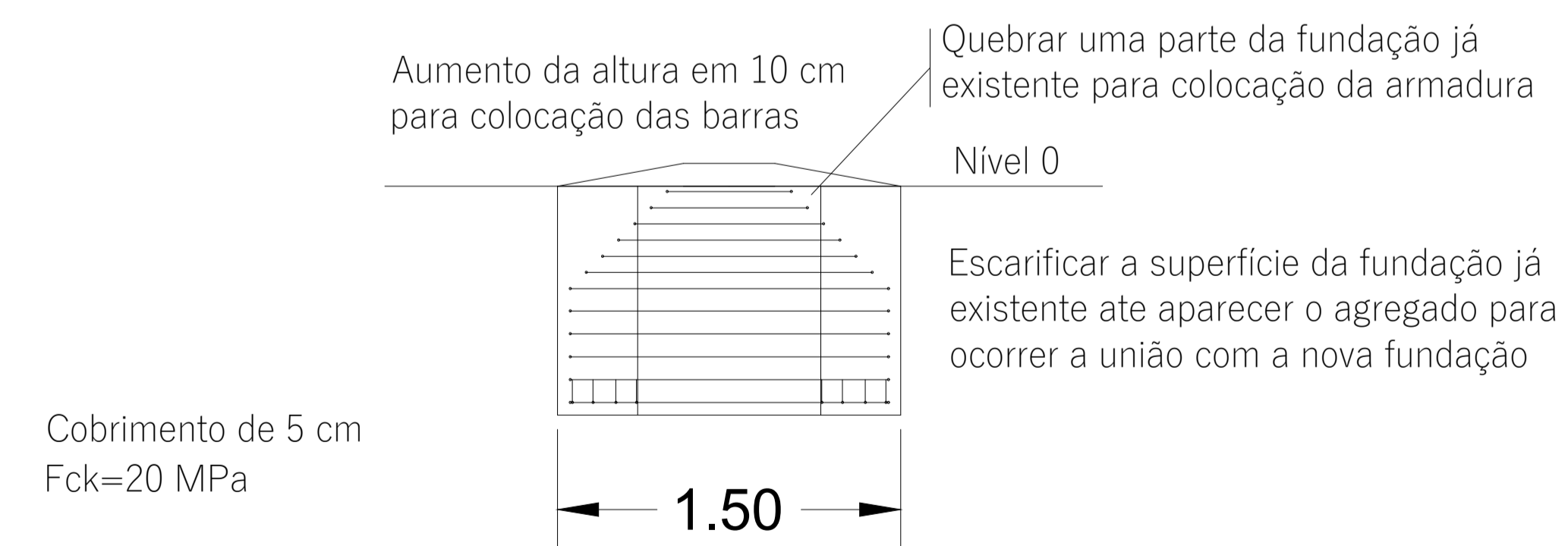

| | | |
|--|---|--|
| RESPONSÁVEL TÉCNICO JOHN SINOCHELLY FERNANDES FERREIRA | OBRA REFORMA, AMPLIAÇÃO E MODERNIZAÇÃO DO MERCADO PÚBLICO - 2ª ETAPA (CONTINUAÇÃO) | PROPRIETÁRIO PREFEITURA DE PAU DOS FERROS |
| DESENHADOR VICTOR VINÍCIUS RÉGO MIRANDA | LOCAL PAU DOS FERROS | PROJETO PROJETO ESTRUTURAL |
| ÁREA 740,15 m² | ESCALA INDICADA | DATA 24/01/2018 |
| | | PROJECION 04/04 |